

# Continuous Drying System

## CDS Models

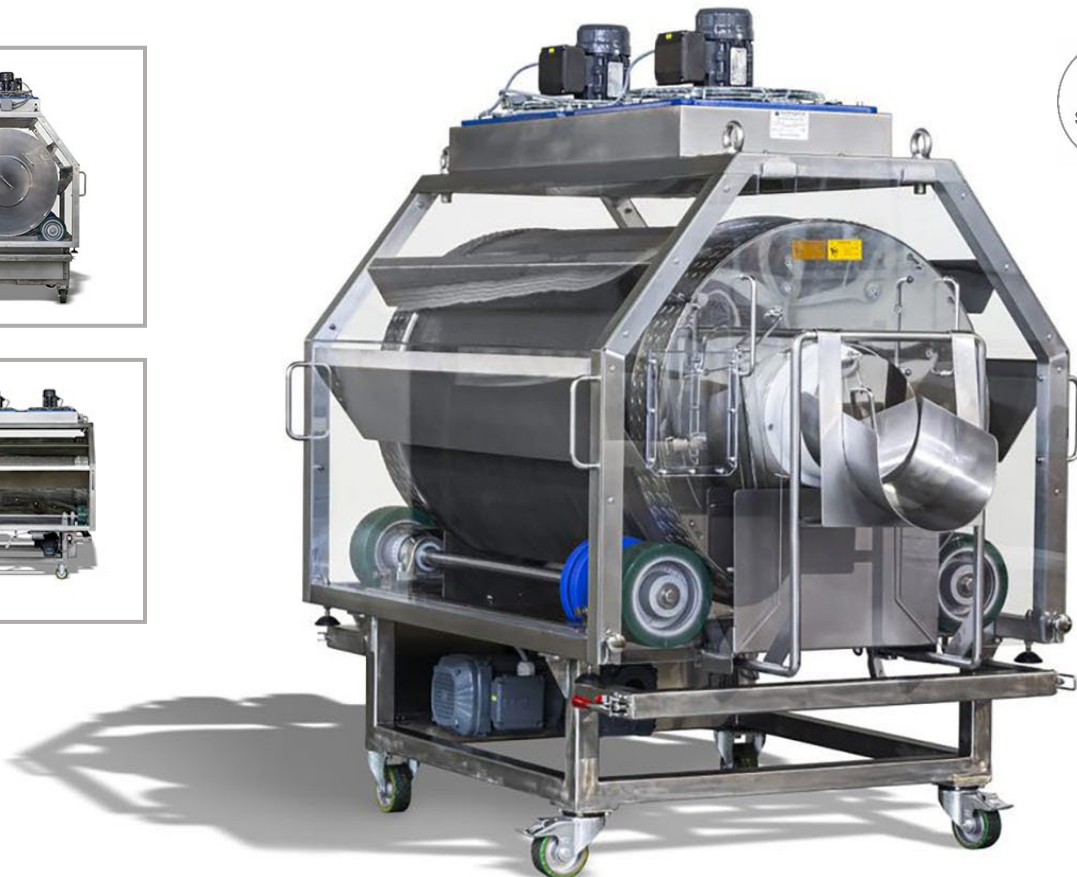

- ✓ COMPLETE DRYING SOLUTIONS FOR HIGH VOLUME  
ENCAPSULATION MACHINES
- ✓ IMPROVE OPERATIONAL COSTS
- ✓ MAXIMIZE OUTPUT WITH UP TO 120KG CAPACITY
- ✓ EASY TO CLEAN & SEAMLESS CHANGEOVER
- ✓ MEETS cGMP STANDARDS

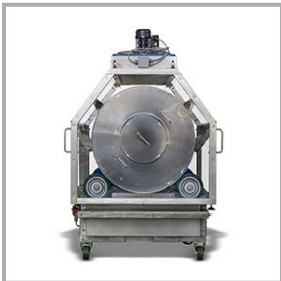

# Continuous Dryers

## CDS Model

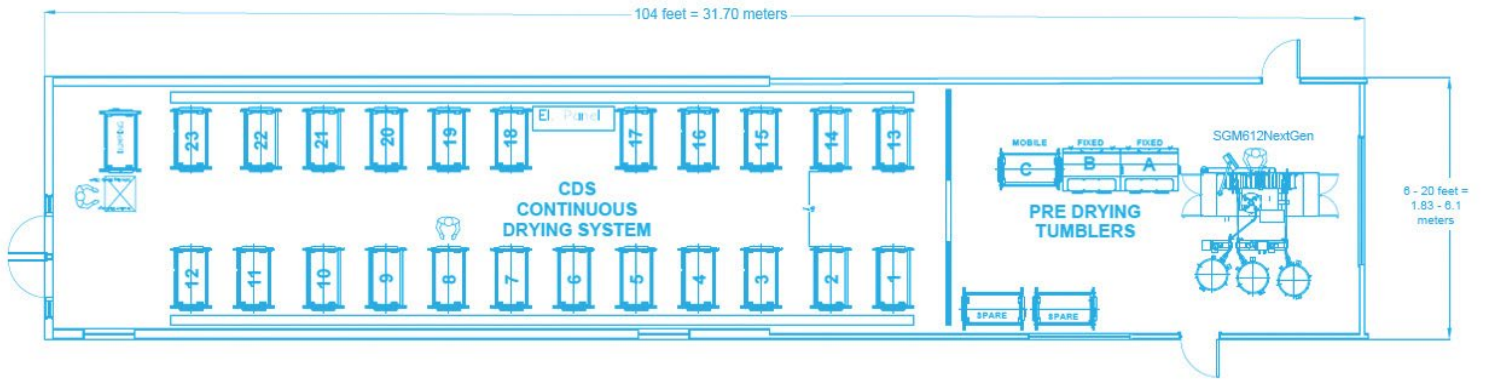

Sample Diagram #1

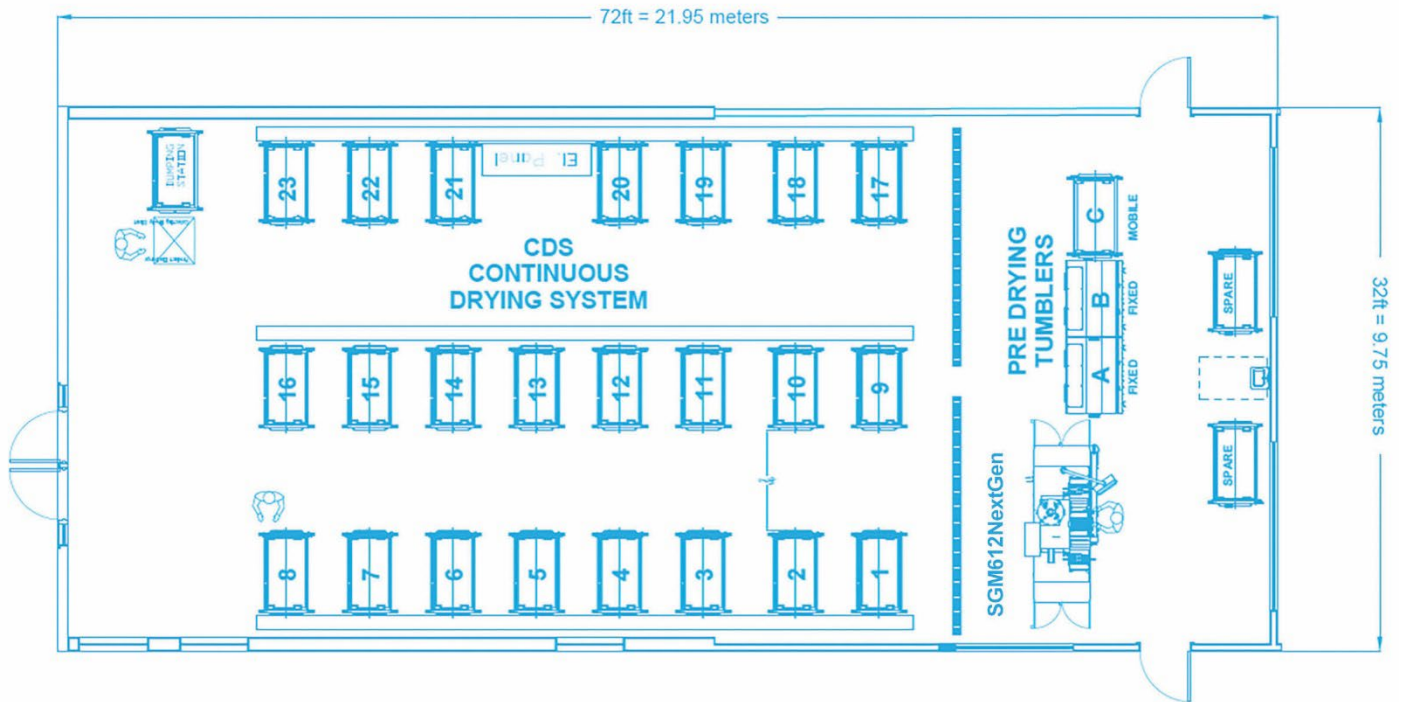

Sample Diagram #2

# Continuous Dryers

## CDS Model

### Efficient Soft Gel Capsule Drying

A Continuous Drying System (CDS) has been designed to provide finished, dried capsules with minimum product handling using 3 drying zones or stages.



#### The system consists of:

- 2 Stationary drying units, which are located by the Soft Gel Machine in the encapsulation room;
- Several mobile drying units, which will be moved from the encapsulation room to the drying room once they are filled with capsules;
- The number of mobile drying units can be customized to Soft Gel Machine output and capacity requirements.

### Drying Zones

1

**Zone 1** - This stage is where product is discharged from the encapsulation machine and is subjected to gentle drying within the stationary units to remove most of the superficial moisture, while firming up the shell for the next zone.

2

**Zone 2** - Capsules are transferred from the encapsulation room to the drying room in the mobile units once capacity is reached. This stage is where product undergoes intensive drying, under high air temperature with low air moisture content.

3

**Zone 3** - This stage is where product completes the drying process and is cooled to reach an equilibrium with the ambient air temperature.

# Continuous Dryers

## CDS Model

### Single Basket Tumble Dryer

#### The CDS Model consists of:

- Design helps facilitates easy of use for drying mechanism and soft gels.
- High-efficiency unit, capable of up to 120kg of wet soft gels.
- The basket driving mechanism uses only high-quality transmission toothed belts, eliminating the need for lubrication, thus avoiding contamination.
- GMP construction, using stainless steel for all exposed surfaces of the unit.
- Exposed hardware limited to a minimum for easy cleaning.
- Advanced safety features.

### Primary Advantages



#### Fast Changeover

Easy to handle and clean the mobile unit.



#### Versatile Air Parameters

Air parameters can be adapted for different product formulations.



#### System Flexibility

Allows for various configurations, limited only



#### Customizable

The number of mobile units can be configured based on various machine sizes and output.



#### Reduced Contamination Risk

Product isolation in each mobile unit reduces the risk of contamination.



#### High-Efficiency

All zones are supplied with dry air without the exposure of external room conditions.

# Continuous Dryers

## CDS Model

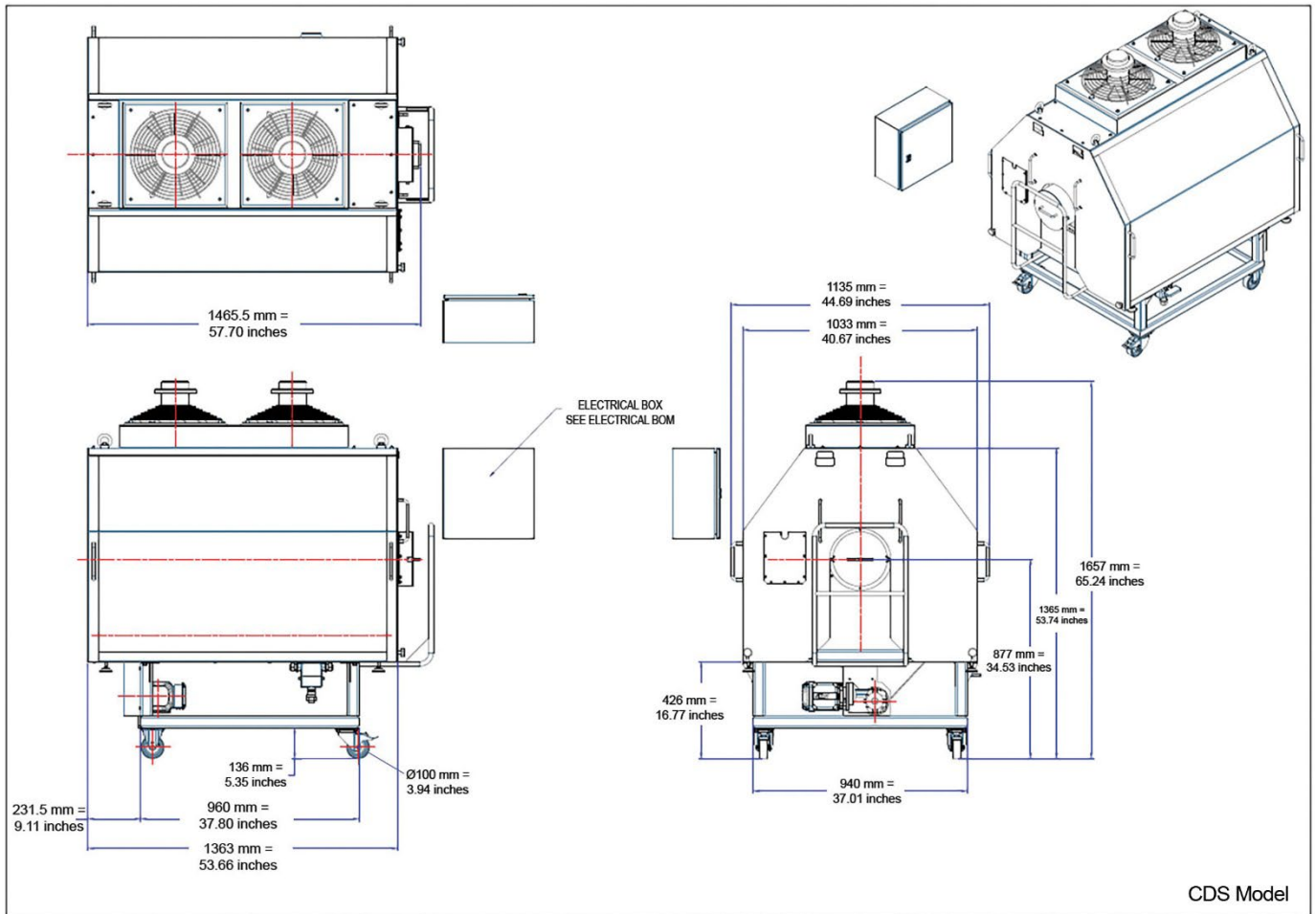

CDS Model

Model No.					
CDS 60KG	Continuous Dryer – up to 60kg Capacity (for standard Bovine Soft Gels)				
CDS 120KG	Continuous Dryer – up to 120kg Capacity (for standard Bovine Soft Gels)				
Weight					
CDS 120KG	<table border="0"> <tr> <td>381kg – Complete Unit</td> <td>84kg – Basket</td> </tr> <tr> <td>90kg – Cover</td> <td>207kg – Cart</td> </tr> </table>	381kg – Complete Unit	84kg – Basket	90kg – Cover	207kg – Cart
381kg – Complete Unit	84kg – Basket				
90kg – Cover	207kg – Cart				
Specifications					
Dimensions (mm/inches)	1135mmL x 1465.5mmW x 1657mmH x / 44.69” L x 57.70” W x 65.24” H				

**TECHNOPHAR**

Technophar Global Headquarters

[www.technophar.com](http://www.technophar.com)

Copyright Technophar ©2022

2022-03-21 rev.